

# 50 WARD®

## MODEL 12

*Best in Class.*

**KNIFE  
GUARANTEE**



**SERRATED TIP  
INCLUDED ON  
WOLVERINE KNIVES**



**FEATURING WOLVERINE**  
LEARN MORE ABOUT WOLVERINE  
[WWW.ZENITHCUTTER.COM/WOLVERINE](http://WWW.ZENITHCUTTER.COM/WOLVERINE)

### STANDARD MALE SLOT KNIVES



**2 HOLES ≈ 1 3/4"**

PART #	M7532-S	M7538-S
DESCRIPTION	SERRATED MALE WITH TIP	SERRATED MALE WITHOUT TIP



**4 HOLES ≈ 3 1/2"**

PART #	M7533-S	M7539-S
DESCRIPTION	SERRATED MALE WITH TIP	SERRATED MALE WITHOUT TIP



**6 HOLES ≈ 5 1/4"**

PART #	M7534-S	M7540-S
DESCRIPTION	SERRATED MALE WITH TIP	SERRATED MALE WITHOUT TIP



**8 HOLES ≈ 7"**

PART #	M7535-S	M7541-S
DESCRIPTION	SERRATED MALE WITH TIP	SERRATED MALE WITHOUT TIP



**10 HOLES ≈ 8 1/2"**

PART #	M7536-S	M7542-S
DESCRIPTION	SERRATED MALE WITH TIP	SERRATED MALE WITHOUT TIP



**12 HOLES ≈ 10"**

PART #	M7537-S	M7543-S
DESCRIPTION	SERRATED MALE WITH TIP	SERRATED MALE WITHOUT TIP



**14 HOLES ≈ 11 1/4"**

PART #	M7551-S	M7561-S
DESCRIPTION	SERRATED MALE WITH TIP	SERRATED MALE WITHOUT TIP

\*NON-SERRATED KNIVES ARE AVAILABLE



**ZENITH CUTTER**  
A FISHER BARTON COMPANY

# 50 WARD® MODEL 12

## GLUEHEAD MALE SLOT KNIVES



	7 INCH	
PART #	M75030-S	M75031-S
DIMENSIONS	SERRATED MALE WITH TIP	SERRATED MALE WITHOUT TIP

### 10 INCH

PART #	M7580-S	M7590-S
DIMENSIONS	SERRATED MALE WITHOUT TIP	SERRATED MALE WITH TIP

\*NON-SERRATED KNIVES ARE AVAILABLE

## FEMALE SLOT KNIVES



PART #	F374	F736	F375	F1788	F1883
DIMENSIONS	13.838 X 10.5 X .375	13.835 X 10.5 X .094	12.25 X 10.5 X .377	13.835 X 10.5 X .094	13.836 X 10.501 X .374
CATEGORY	STANDARD	THIN/PINCH RING	SPACER	DIRT GROOVE THIN/PINCH RING	STANDARD WITH DIRT GROOVE

## TRIM KNIVES



PART #	G1154	G873	G954	G953
DESCRIPTION	UPPER TRIM KNIFE	LOWER TRIM KNIFE	UPPER TRIM KNIFE	LOWER TRIM KNIFE
DIMENSIONS	16.438 X 13.25 X .375	14.32 X 11.25 X .5	12.438 X 9.0 X .375	12.27 X 9.0 X .375

## STRIPPERS



PART #	C787323_8	D282903_8
DESCRIPTION		
DIMENSIONS	9.916 X .360	5.859 X .360

## SCORE RINGS



CONTACT ZENITH SALES

"A" PROFILE

## SCORE RINGS



CONTACT ZENITH SALES

WAVY "A" PROFILE

## TAB KNIVES



PART #	J1519	J828	J1520	J681
DESCRIPTION	OFFSET SLOT	CENTER SLOT	OFFSET SLOT	CENTER SLOT
DIMENSIONS	1-5/8 X .970 X .060	1-5/8 X .937 X .060	1-5/8 X 1.050 X .060	1-5/8 X 1.050 X .060

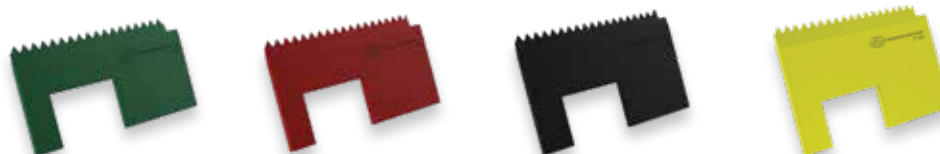

### 1-5/8 INCH FOR URETHANE ANVIL

PART #	P1886	P1887	P1888	P1889
DESCRIPTION	B FLUTE TAB KNIFE	C FLUTE TAB KNIFE	BC FLUTE TAB KNIFE	AC FLUTE TAB KNIFE
DIMENSIONS	1-5/8 X .813 X .060	1-5/8 X .875 X .060	1-5/8 X .97 X .060	1-5/8 X 1.05 X .060

### 2 INCH FOR URETHANE ANVIL

PART #	P531	P532	P533	P534-AC
DESCRIPTION	B FLUTE TAB KNIFE	C FLUTE TAB KNIFE	BC FLUTE TAB KNIFE	AC FLUTE TAB KNIFE
DIMENSIONS	2 X .813 X .060	2 X .875 X .060	2 X .97 X .060	2 X 1.05 X .060

## URETHANE BLANKET



PART #	ZU8500
DESCRIPTION	BAR LOCK
DIMENSIONS	9.937 X .3

## STITCH ANVILS



ZU3289C	ZU3565C
1.906 X .300	3 X .300

## CREASER ANVILS



PART #	ZU267598	ZU146408	ZU121737
DESCRIPTION	DUROMETER 65A	DUROMETER 75A	DUROMETER 85A

# 50 WARD® MODEL 12

## UPPER & LOWER SHAFT ASSEMBLY

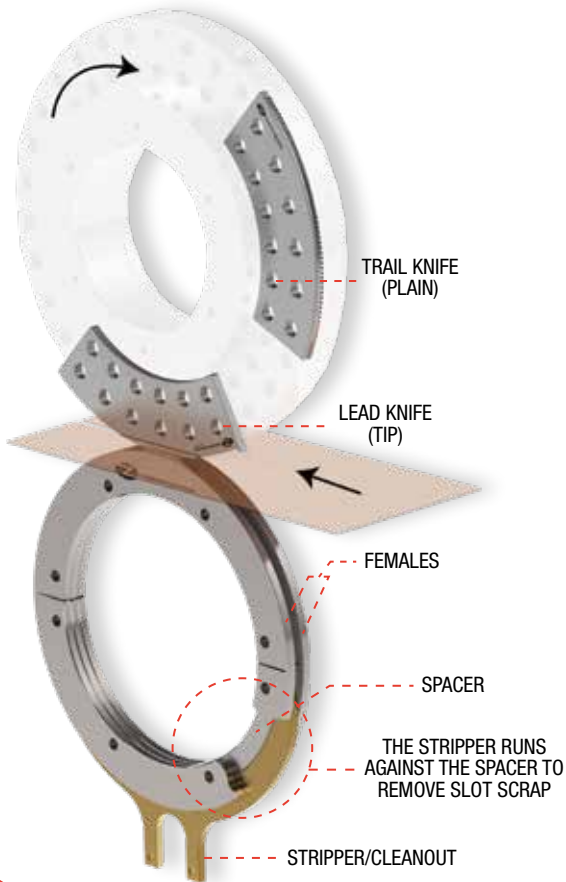

## MALE STANDARD ASSEMBLY

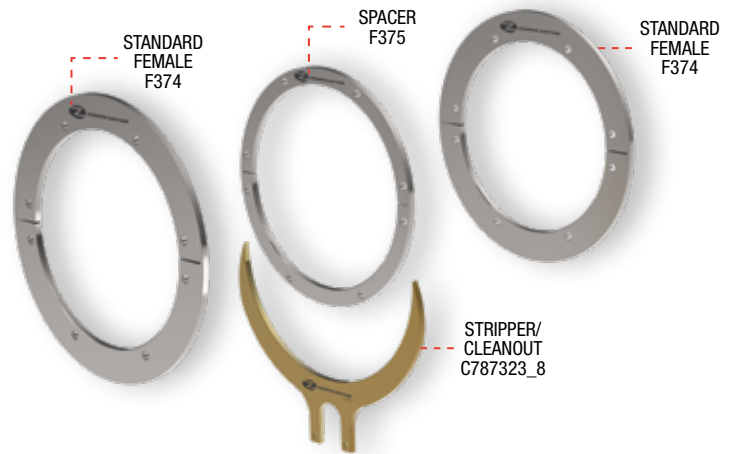

### BEST IN CLASS. GUARANTEED.

We guarantee our knives will perform, as well or, better than the rest. Why? Because making knives is what we do and we do it better than anyone else. Through extensive engineering and research, we make the best knives on the planet.

*Best in Class.*

**KNIFE  
GUARANTEE**

5200 Zenith Parkway  
Loves Park, IL 61111

815.282.5200  
800.223.5202 (US)  
800.228.5206 (Canada)

zenithcutter.com

sales@zenithcutter.com



**ZENITH CUTTER**  
A FISHER BARTON COMPANY

