

38 S&S®

ZLG-ZLM 701 REPLACEMENT KNIVES & ACCESSORIES

FEATURING



WOLVERINE™



Best in Class.

**KNIFE
GUARANTEE**



ZENITH CUTTER



A FISHER BARTON COMPANY

38 S&S® REPLACEMENT KNIVES



*FEATURING WOLVERINE

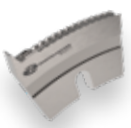

STANDARD MALE SLOT KNIVES

		3 INCH				6 INCH	
	PART #	M5405-S	M5453-S		PART #	M5406-S	M5456-S
	DESCRIPTION	SERRATED MALE WITH TIP	SERRATED MALE WITHOUT TIP			SERRATED MALE WITH TIP	SERRATED MALE WITHOUT TIP
		8 INCH				10 INCH	
	PART #	M5408-S	M5458-S		PART #	M5410-S	M5460-S
	DESCRIPTION	SERRATED MALE WITH TIP	SERRATED MALE WITHOUT TIP			SERRATED MALE WITH TIP	SERRATED MALE WITHOUT TIP

FEMALE SLOT KNIVES

			
PART #	F669	F693	F725
DIMENSIONS	9.156 X 6.25 X 0.312	9.154 X 6.251 X .094	7.5 X 6.25 X 0.377
CATEGORY	STANDARD	THIN/PINCH RING	SPACER
			
PART #	F196	F591	F718
DIMENSIONS	12.750 X 9.501 X .313	12.750 X 9.501 X .094	11.000 X 9.501 X .377
CATEGORY	STANDARD	THIN/PINCH RING	SPACER

TRIM KNIVES

			
PART #	G456	P394	G931
DESCRIPTION	PERFORMANCE UPPER	STRAIGHT UPPER	LOWER SLITTER
DIMENSIONS	13.625 X 10.25 X .250	13.625 X 10.25 X .250	9.188 X 6.25 X .313

SCORE RINGS

CONTACT ZENITH SALES
"A" PROFILE

▶ GLUEHEAD MALE SLOT KNIVES



10 INCH

PART #	M5420-S	M5413-S
DESCRIPTION	SERRATED MALE WITH TIP, EXTENDED SLOT AND BEVEL	SERRATED MALE WITHOUT TIP, EXTENDED SLOT AND BEVEL

▶ TAB KNIVES



1-5/8 INCH FOR URETHANE ANVIL

PART #	P1886	P1887	P1888	P1889
DESCRIPTION	B FLUTE TAB KNIFE	C FLUTE TAB KNIFE	BC FLUTE TAB KNIFE	AC FLUTETAB KNIFE
DIMENSIONS	1-5/8 X .813 X .060	1-5/8 X .875 X .060	1-5/8 X .970 X .060	1-5/8 X 1.05 X .060

2 INCH FOR URETHANE ANVIL

PART #	P531	P532	P533	P534-AC
DESCRIPTION	B FLUTE TAB KNIFE	C FLUTE TAB KNIFE	BC FLUTE TAB KNIFE	AC FLUTE TAB KNIFE
DIMENSIONS	2 X .813 X .060	2 X .875 X .060	2 X .970 X .060	2 X 1.05 X .060

▶ STRIPPER/CLEANOUT



PART #	701-021913_8	ZLM180-03_8
REFERENCE SPACER	F725	F718

▶ DOCTOR BLADES



PART #	DBU0815
DIMENSIONS	1.5" X .080" X 100'
MATERIAL	UHMW

▶ HARDWARE



1/2 INCH

PART #	1_2-31_2TB	1_2-11_2TB	1_2FNHEAVY
DESCRIPTION	1/2 X 3-1/2 T BOLT SQUARE HEAD	1/2 X 1-1/2 T BOLT SQUARE HEAD	1/2 FLANGE NUT (HEAVY DUTY)
DIMENSIONS	3.5 X 1/2	1.5 X 1/2	

3/8 INCH

PART #	3_8-21_2TB	3_8-11_8TB	3_8FNHEAVY
DESCRIPTION	3/8 X 2-1/2 T BOLT SQUARE HEAD	3/8 X 1-1/8 T BOLT SQUARE HEAD	3/8 FLANGE NUT (HEAVY DUTY)
DIMENSIONS	2.5 X 3/8	1.125 X 3/8	

FOR A FULL LIST OF ZENITH PRODUCTS, CALL 800-223-5202

38 S&S® REPLACEMENT KNIVES

▶ MALE GLUEHEAD ASSEMBLY

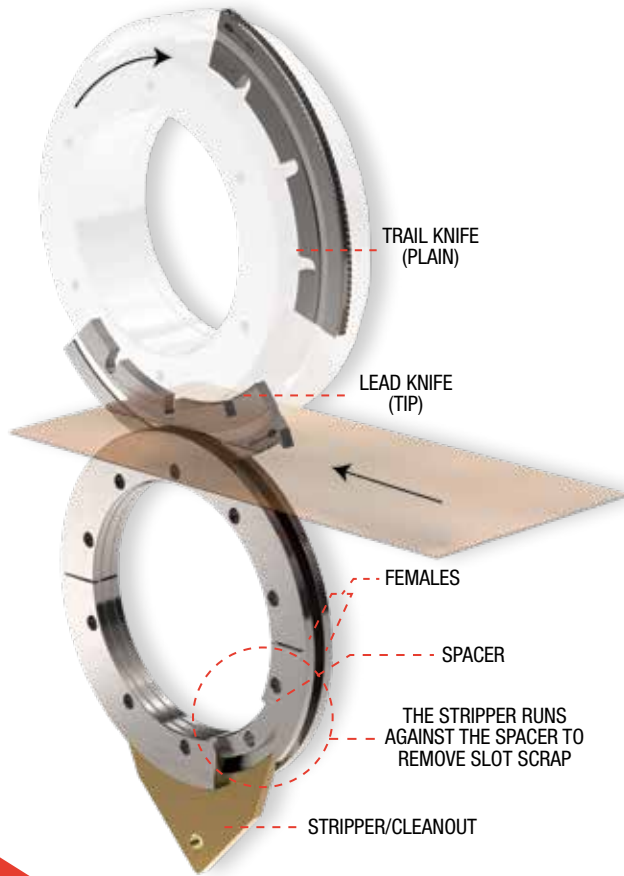

▶ STANDARD FEMALE ASSEMBLY

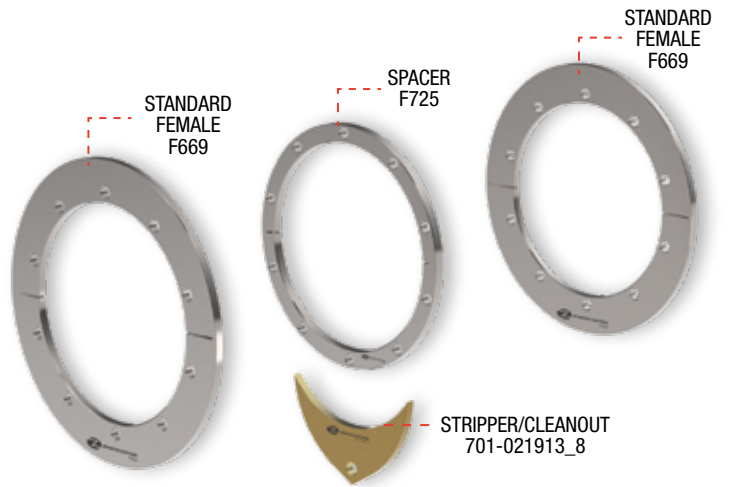

BEST IN CLASS. GUARANTEED.

We guarantee our knives will perform, as well or better than the rest. Why? Because making knives is what we do and we do it better than anyone else. Through extensive engineering and research, we make the best knives on the planet.

Best in Class.

**KNIFE
GUARANTEE**

5200 Zenith Parkway
Loves Park, IL 61111

815.282.5200
800.223.5202 (US)
800.228.5206 (Canada)

zenithcutter.com

sales@zenithcutter.com



ZENITH CUTTER
A FISHER BARTON COMPANY



SMITHERS
QUALITY ASSESSMENTS